

F:\PROJECTS\170142 WIGGLY BRIDGE DIST. ANNEX CIVIL\3D\DWG\17-0142_SITE_REV2.DWG 8/2/2017 6:02 PM

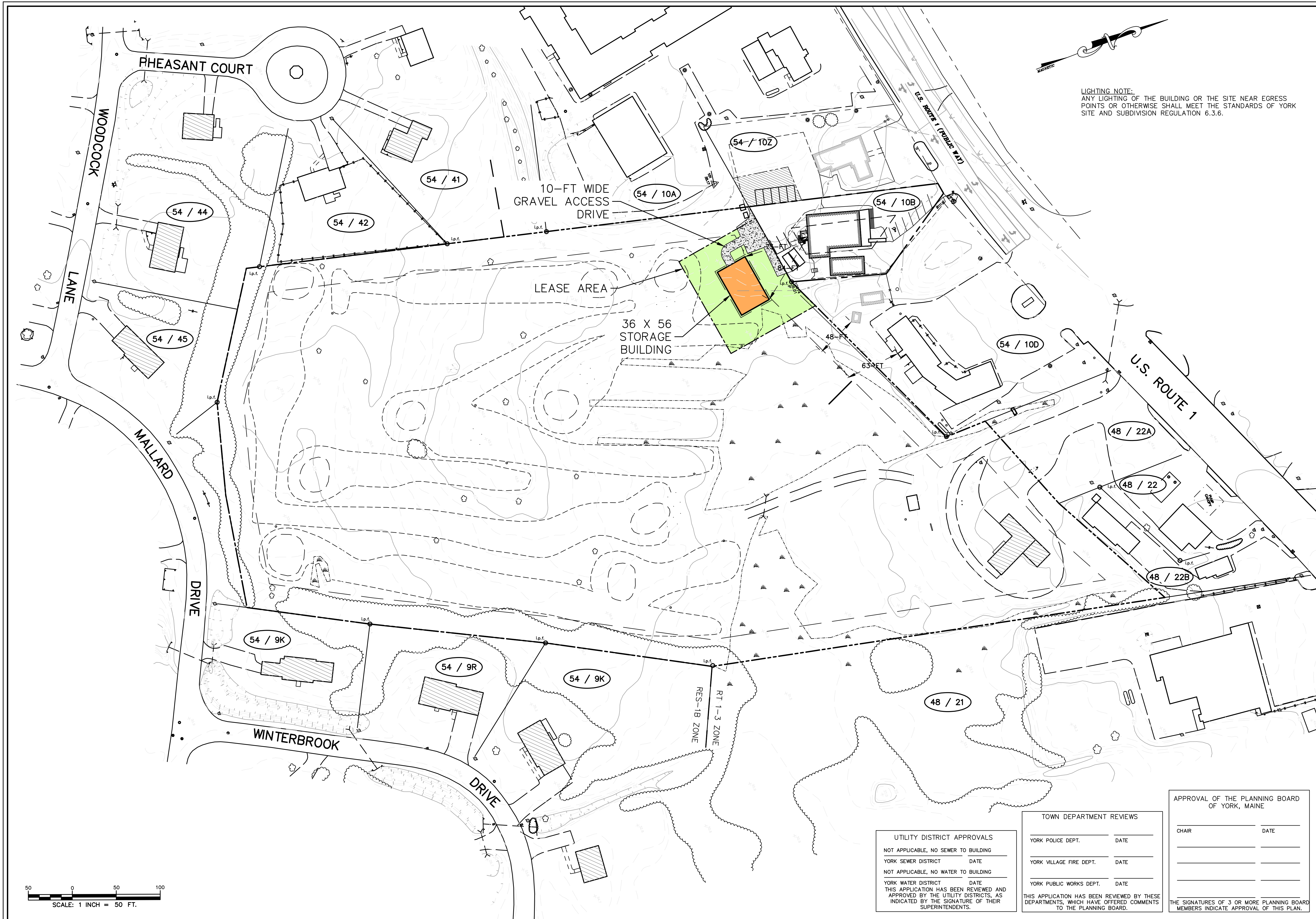

LIGHTING NOTE:
 ANY LIGHTING OF THE BUILDING OR THE SITE NEAR EGRESS POINTS OR OTHERWISE SHALL MEET THE STANDARDS OF YORK SITE AND SUBDIVISION REGULATION 6.3.6.

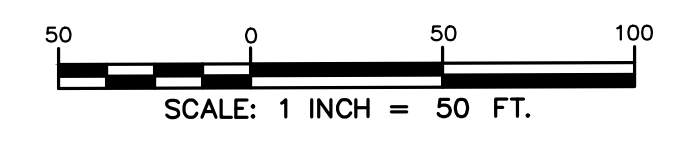
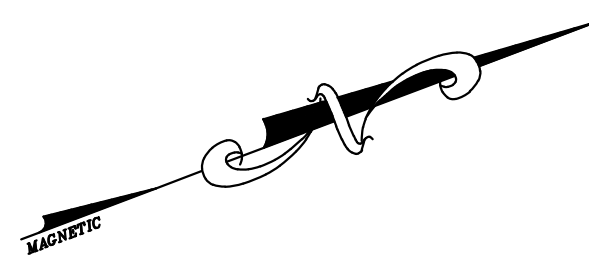

UTILITY DISTRICT APPROVALS
 NOT APPLICABLE, NO SEWER TO BUILDING
 YORK SEWER DISTRICT DATE _____
 NOT APPLICABLE, NO WATER TO BUILDING
 YORK WATER DISTRICT DATE _____
 THIS APPLICATION HAS BEEN REVIEWED AND APPROVED BY THE UTILITY DISTRICTS, AS INDICATED BY THE SIGNATURE OF THEIR SUPERINTENDENTS.

TOWN DEPARTMENT REVIEWS
 YORK POLICE DEPT. DATE _____
 YORK VILLAGE FIRE DEPT. DATE _____
 YORK PUBLIC WORKS DEPT. DATE _____
 THIS APPLICATION HAS BEEN REVIEWED BY THESE DEPARTMENTS, WHICH HAVE OFFERED COMMENTS TO THE PLANNING BOARD.

APPROVAL OF THE PLANNING BOARD OF YORK, MAINE
 CHAIR _____ DATE _____

 THE SIGNATURES OF 3 OR MORE PLANNING BOARD MEMBERS INDICATE APPROVAL OF THIS PLAN.

NO.	DATE	REVISION	DESIGNED:	CHECKED:	APPROVED:
2	08/17	REVISED BUILDING LOCATION	RRL	RRL	RRL
1	06/17	REVISED BUILDING SIZE	RRL	RRL	RRL
DRAWN:	DAD				

CONSULTING ENGINEERS
 Inc.
 316 U.S. Route 1, Suite D • York, ME 03909
 (207) 363-0669 • Fax: (207) 363-2364
 cd@cldeengineers.com • www.cldeengineers.com
 Maine • New Hampshire • Vermont

STATE OF MAINE
 RICHARD LUNDBORN
 No. 13831
 [Signature]
 08-03-17

CLIENT:
DAVID C. WOODS
JUDY A. WOODS
 21 RAILROAD AVENUE
 YORK, MAINE 03909

TAX MAP 54 LOT 10-C
WIGGLY BRIDGE DISTILLERY
STORAGE BUILDING
 445 U.S. ROUTE 1
 YORK, MAINE 03909

SITE PLAN
 SCALE: 1"=50'
 JOB NO. 17-0142
 DATE: AUG. 2017
 DWG. 1 OF 1